

S | A | W

CONTRACT FURNITURE

Established in 1991 as a family business, S.A.W. Ltd. has undergone major expansion and restructuring to exceed growing expectations from customers and the highest standards in the industry. Operating from a new state-of-the-art facility with 6000 square meters foot print dedicated to the manufacturing facility, offices and show areas, S.A.W. Ltd. strives to be an imaginative, competitive and timely blue chip supplier of contract furniture to both foreign and local customers, and achieve excellence in this field.

Over these years, the company has successfully managed a large number of high profile contracts for a variety of customers. Projects were implemented in central and Eastern Europe as well as in North Africa, allowing the company to become a leading manufacturer of quality furniture with an array of quality projects in its portfolio. S.A.W. Ltd. thrives by targeting technically challenging projects, as well as projects where logistical constraints necessitate a high degree of service.

The company's main areas of expertise are in the manufacturing of quality furniture for public areas, bars and pubs, restaurants, retail outlets, hotel rooms and luxury residences. S.A.W. Ltd. ensures that for each and every project it provides its customers with a complete one stop shop solution taking designer drawings from concept to completion. Additional materials such as stainless steel, metals, glass, marble, upholstery and refrigeration equipment, can be integrated in the finished project and supplied installed, ready to use.

S.A.W. Ltd. is an innovative, client-driven, service-oriented company that takes pride in aiding customers on projects of any size.



DESIGN SOURCE INTERNATIONAL



KEVIN BURTON



SEAN ARRIGO



KEN BEATTIE



DEMICOLO & ASSOCIATES



ARTEC CONTRACT DESIGN



ARTEC CONTRACT DESIGN



DESIGN SOURCE INTERNATIONAL



SEAN ARRIGO



DESIGN SOURCE INTERNATIONAL

contract **furniture** specialists

1. Plans are drawn up by the interior designer or client.



Our Quality Policy

- Consistently provide value added products and services at a level of quality that meets or exceeds the expectation of our customers.
- Continuously evaluate and improve our operational consistency, productivity and efficiency in order to strive for excellence.
- Provide a system for employee involvement, motivation and training.
- Maintain Health & Safety and Environmental compliance by awareness training.

2. Working drawings are produced

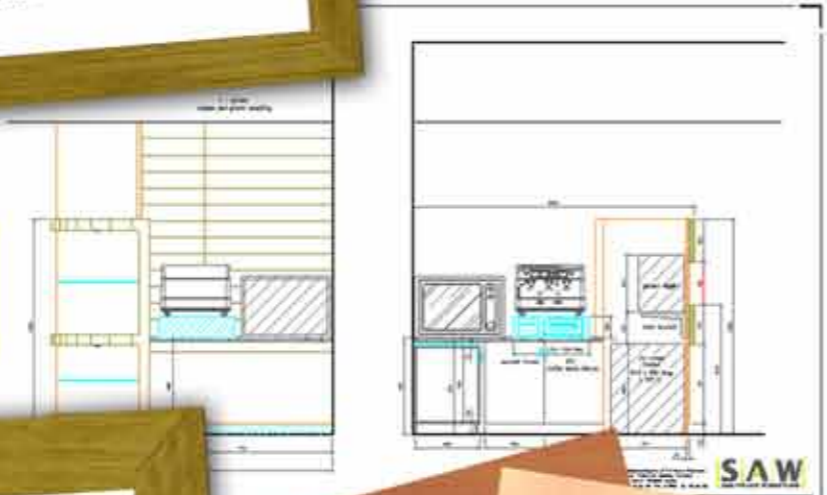

Our Environmental, Health & Safety Policy

We consider that none of our activities is more important than the health and safety of any individual or the protection of the environment

- We will comply with applicable EHS laws, regulations and company standards;
- We will protect the health and safety of our employees, visitors and others affected by our operations;
- We are committed to the continuous improvement of our environment, health and safety performance;
- We will strive to remove all causes for accidents;
- We will consult effectively with our employees and other stakeholders on EHS matters;
- We will encourage a proactive culture and ensure that employees are trained, experienced and competent to perform their duties.

3. Materials are selected and prototypes produced (for large projects)

4. Quality workmanship and state-of-the-art equipment



5. The finished furniture is installed on site.

